

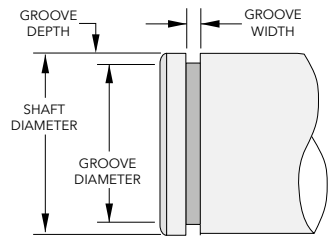

XXDS Series

Constant Section Imperial Rings External

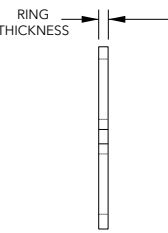
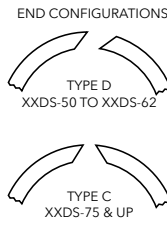
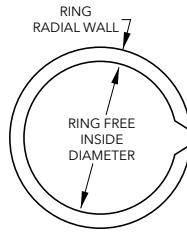

Product Dimensions: All dimensions in inches unless otherwise specified.

TFC Part Number ³		Shaft Diameter		Ring			Groove		Thrust Capacity	
Carbon Steel	Add Suffix	mm	in	Inside Diameter (in)	Radial Wall (in)	Thickness (in)	Diameter (in)	Width (in)	Groove Yield ¹ (lb)	Ring Shear ² (lb)
	302 SS									
XXDS-50	-S02	12,70	0,500	0,465	0,048	0,035	0,474	0,039	459	2,073
XXDS-62	-S02	15,88	0,625	0,587	0,062	0,035	0,597	0,039	619	2,592
XXDS-75	-S02	19,05	0,750	0,704	0,078	0,042	0,716	0,046	901	3,770
XXDS-87	-S02	22,23	0,875	0,823	0,093	0,042	0,833	0,046	1,299	4,398
XXDS-100	-S02	25,40	1,000	0,944	0,094	0,042	0,954	0,046	1,626	5,027
XXDS-112	-S02	28,58	1,125	1,065	0,125	0,042	1,077	0,046	1,909	5,655
XXDS-118	-S02	30,15	1,187	1,120	0,125	0,042	1,135	0,046	2,182	5,967
XXDS-125	-S02	31,75	1,250	1,179	0,125	0,042	1,194	0,046	2,474	6,283
XXDS-131	-S02	33,32	1,312	1,232	0,125	0,042	1,252	0,046	2,782	6,595
XXDS-137	-S02	34,93	1,375	1,289	0,125	0,042	1,309	0,046	3,207	6,912
XXDS-143	-S02	36,50	1,437	1,349	0,125	0,042	1,369	0,046	3,454	7,223
XXDS-150	-S02	38,10	1,500	1,410	0,125	0,042	1,430	0,046	3,711	7,540
XXDS-162	-S02	41,28	1,625	1,520	0,156	0,042	1,545	0,046	4,595	8,168
XXDS-168	-S02	42,85	1,687	1,582	0,156	0,042	1,607	0,046	4,770	8,480
XXDS-175	-S02	44,45	1,750	1,645	0,156	0,042	1,670	0,046	4,948	8,796
XXDS-193	-S02	49,20	1,937	1,832	0,156	0,042	1,857	0,046	5,477	9,736
XXDS-200	-S02	50,80	2,000	1,895	0,156	0,042	1,920	0,046	5,655	10,053
XXDS-218	-S02	55,55	2,187	2,082	0,156	0,042	2,107	0,046	6,184	10,993
XXDS-225	-S02	57,15	2,250	2,145	0,156	0,042	2,170	0,046	6,362	11,310
XXDS-237	-S02	60,33	2,375	2,270	0,156	0,042	2,295	0,046	6,715	11,938
XXDS-250	-S02	63,50	2,500	2,390	0,156	0,042	2,420	0,046	7,069	12,566
XXDS-275	-S02	69,85	2,750	2,596	0,187	0,062	2,626	0,068	12,052	19,369
XXDS-293	-S02	74,60	2,937	2,783	0,187	0,062	2,813	0,068	12,871	20,687
XXDS-300	-S02	76,20	3,000	2,846	0,187	0,062	2,876	0,068	13,148	21,130
XXDS-312	-S02	79,38	3,125	2,965	0,187	0,062	3,000	0,068	13,806	22,011
XXDS-325	-S02	82,55	3,250	3,090	0,187	0,062	3,125	0,068	14,358	22,891
XXDS-337	-S02	85,73	3,375	3,215	0,187	0,062	3,250	0,068	14,910	23,772
XXDS-350	-S02	88,90	3,500	3,340	0,187	0,062	3,375	0,068	15,463	24,652
XXDS-375	-S02	95,25	3,750	3,570	0,218	0,078	3,610	0,086	18,555	31,809
XXDS-400	-S02	101,60	4,000	3,820	0,218	0,078	3,860	0,086	19,792	33,929
XXDS-425	-S02	107,95	4,250	4,070	0,218	0,078	4,110	0,086	21,029	36,050
XXDS-450	-S02	114,30	4,500	4,320	0,218	0,078	4,360	0,086	22,266	38,170
XXDS-475	-S02	120,65	4,750	4,560	0,218	0,078	4,610	0,086	23,503	40,291
XXDS-500	-S02	127,00	5,000	4,800	0,218	0,078	4,860	0,086	24,740	42,412
XXDS-550	-S02	139,70	5,500	5,280	0,250	0,093	5,340	0,103	31,102	55,983
XXDS-600	-S02	152,40	6,000	5,775	0,250	0,093	5,840	0,103	33,929	61,073
XXDS-650	-S02	165,10	6,500	6,270	0,250	0,093	6,340	0,103	36,757	66,162
XXDS-700	-S02	177,80	7,000	6,765	0,250	0,093	6,840	0,103	39,584	71,251
XXDS-750	-S02	190,50	7,500	7,245	0,281	0,109	7,320	0,120	47,713	85,750
XXDS-800	-S02	203,20	8,000	7,740	0,281	0,109	7,820	0,120	50,894	91,466

¹ Based on a groove material yield strength of 45000 psi and a safety factor of 2.

² Based on a safety factor of 3.

³ Square edge wire.

* See page 99 for different End Types.